

# ProChipper®

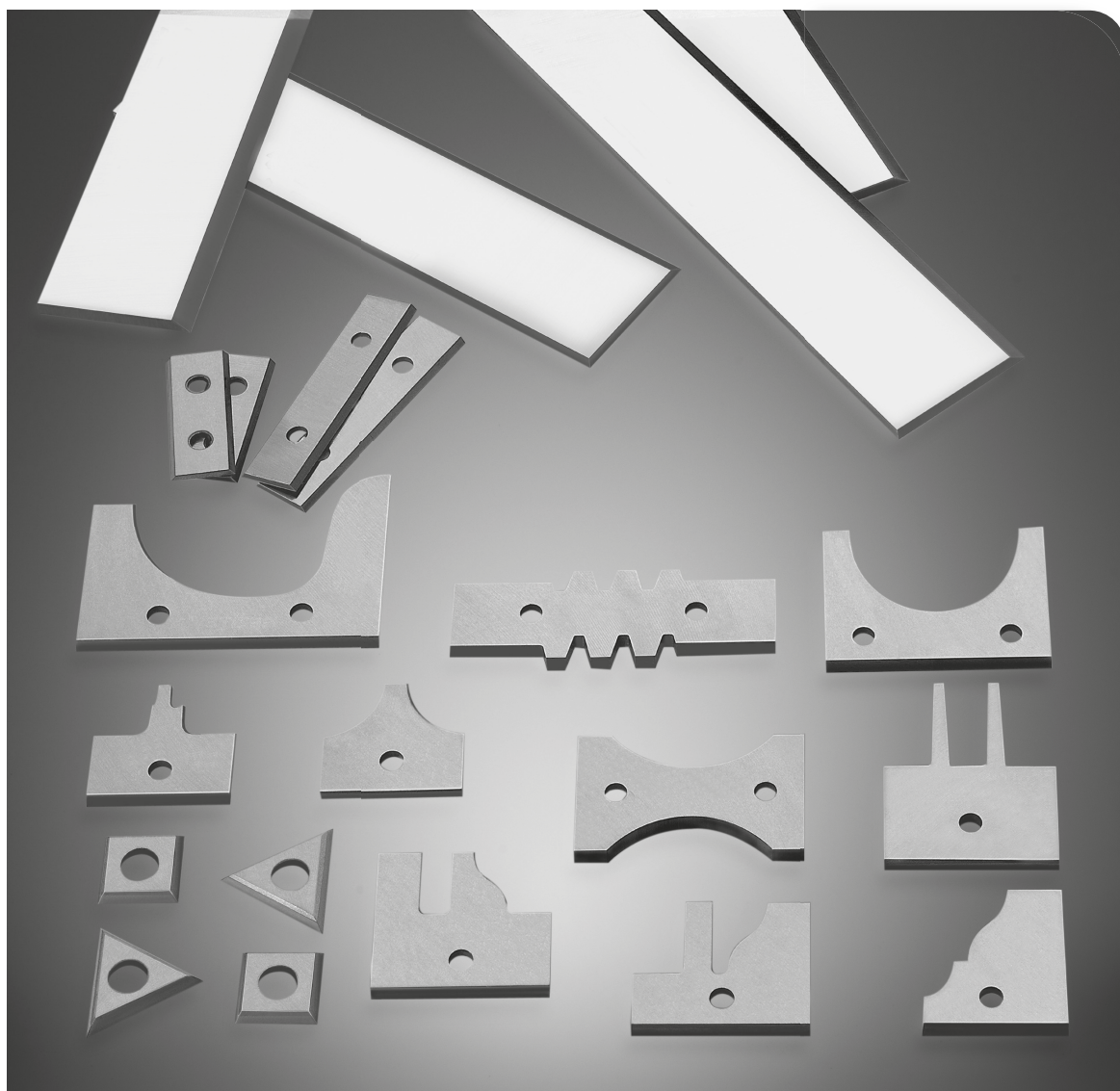

tooling systems



**Messer, Ersatzteile und Hilfsmittel**  
*Knives, spare parts and toolinh accessories*

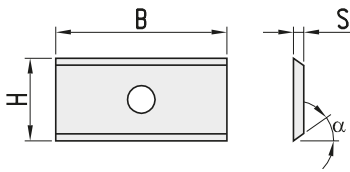

- HF21:** Für Weichholz  
*For Softwood*
- HF10:** Standardqualität  
*For wood*
- HF01:** Für MDF und abrasive Werkstoffe  
*For abrasive materials (chipboard/MDF)*
- FMG02:** Für MDF und HDF  
*For MDF and HDF*
- KCR08:** Für erhöhte Standzeiten  
*For longer endurance*  
Auf Anfrage - *On request*

**Ausführung 1: 2 Schneidkanten, 1 Loch**  
*Type 1: 2 cutting edges, 1 hole*
**HW**

B	H	S	$\alpha$	Körnung/Grain	Art. Nr.
<b><math>\alpha = 35^\circ</math></b>					
7,5	12	1,5	35°	HF10	<b>750.097</b>
	12	1,5	45°	HF21	<b>752.501</b>
8,6	12	1,5	35°	HF10	<b>750.095</b>
9,0	12	1,5	35°	HF10	<b>750.096</b>
9,6	12	1,5	35°	HF10	<b>750.098</b>
	12	1,5	45°	HF21	<b>752.502</b>
10,5	12	1,5	35°	HF10	<b>750.200</b>
11,0	12	1,5	35°	HF10	<b>750.209</b>
11,6	12	1,5	35°	HF10	<b>750.099</b>
	12	1,5	45°	HF21	<b>750.503</b>
13,0	12	1,5	35°	HF10	<b>750.202</b>
14,6	12	1,5	35°	HF10	<b>750.201</b>
15,0	12	1,5	35°	HF10	<b>750.101</b>
	12	1,5	45°	HF21	<b>750.504</b>
15,7	12	1,5	35°	HF10	<b>750.203</b>
16,0	12	1,5	35°	HF10	<b>750.206</b>
17,0	12	1,5	35°	HF10	<b>750.115</b>
17,6	12	1,5	35°	HF10	<b>750.205</b>
19,6	12	1,5	35°	HF10	<b>750.208</b>
20,0	12	1,5	35°	HF10	<b>750.102</b>
	12	1,5	35°	HF01	<b>751.104</b>
	12	1,5	35°	FMG02	<b>752.101</b>
	12	1,5	45°	HF21	<b>752.505</b>
21,6	12	1,5	35°	HF10	<b>750.204</b>
24,7	12	1,5	35°	HF10	<b>750.103</b>
<b><math>\alpha = 45^\circ</math></b>					
7,5	12	1,5	45°	HF21	<b>752.501</b>
9,6	12	1,5	45°	HF21	<b>752.502</b>
11,6	12	1,5	45°	HF21	<b>752.503</b>
15,0	12	1,5	45°	HF21	<b>752.504</b>
20,0	12	1,5	45°	HF21	<b>752.505</b>

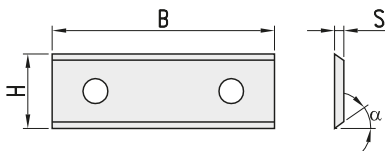

**Ausführung 2: 2 Schneidkanten, 2 Löcher**  
*Type 2: 2 cutting edges, 2 holes*
**HW**

B	H	S	$\alpha$	Körnung/Grain	Art. Nr.
<b><math>\alpha = 35^\circ</math></b>					
30	12	1,5	35°	HF10	<b>750.104</b>
30	12	1,5	35°	HF01	<b>751.105</b>
30	12	1,5	35°	FMG02	<b>752.102</b>
40	12	1,5	35°	HF10	<b>750.105</b>
50	12	1,5	35°	HF10	<b>750.106</b>
50	12	1,5	35°	HF01	<b>751.107</b>
50	12	1,5	35°	FMG02	<b>752.103</b>
60	12	1,5	35°	HF10	<b>750.107</b>
80	12	2,2	35°	HF10	<b>750.108</b>
100	12	2,2	35°	HF10	<b>750.109</b>
120	12	2,2	35°	HF10	<b>750.110</b>
<b><math>\alpha = 45^\circ</math></b>					
30	12	1,5	45°	HF21	<b>752.507</b>
40	12	1,5	45°	HF21	<b>752.508</b>
50	12	1,5	45°	HF21	<b>752.509</b>
60	12	1,5	45°	HF21	<b>752.510</b>
80	12	2,2	45°	HF21	<b>752.511</b>

753/4

**HW Wendemesser 4-seitig**  
*TC Reversible knives 4-cutting edges*

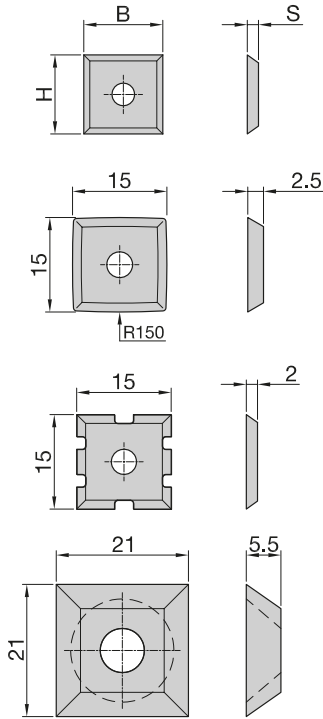
PG  
02



Ausführung 1 - Type 1

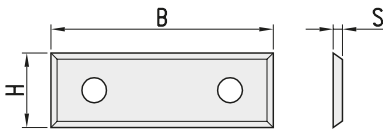

Ausführung 2 - Type 2

**Ausführung 1: 4 Schneidkanten, 1 Senkloch**  
*Type 1: 4 cutting edges, 1 sinkhole*

HW

B	H	S	Körnung/Grain	Art. Nr.
12,0	12,0	1,5	HF10	754.102
	12,0	1,5	FMG02	752.100
14,0	14,0	2,0	HF10	750.111
	14,0	1,7		750.112
	14,0	1,2		750.113
14,3	14,3	2,5		750.116
15,0	15,0	2,0	SPB/Chipbreaker	754.301
	15,0	2,5	ballig	754.106
17,0	17,0	2,0	HF10	754.104
19,0	19,0	2,0	HF10	754.105
21,0	21,0	5,5		754.302

- HF21:** Für Weichholz  
*For Softwood*
  - HF10:** Standardqualität  
*For wood*
  - HF01:** Für MDF und abrasive Werkstoffe  
*For abrasive materials (chipboard/MDF)*
  - FMG02:** Für MDF und HDF  
*For MDF and HDF*
  - KCR08:** Für erhöhte Standzeiten  
*For longer endurance*
- Auf Anfrage - *On request*

**Ausführung 2: 4 Schneidkanten, 2 Löcher**  
*Type 2: 4 cutting edges, 2 holes*

HW

B	H	S	Körnung/Grain	Art. Nr.
29,5	9	1,5	HF10	753.204
	12	1,5	HF10	753.207
49,5	9	1,5		753.204
	12	1,5	HF10	753.307
50,0	12	1,7	HF10	753.350

753/4

**HW Wendemesser mit Fase**  
*TC Reversible knives with chamfer*

PG  
02

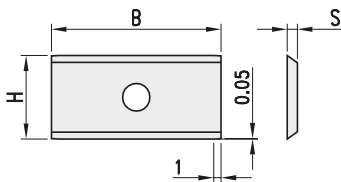

**Für Aufbausystem**  
*For built-up system*

HW

B	H	S	Art. Nr.
20,0	12	1,5	755.101
24,7	12	1,5	755.102
30,0	12	1,5	755.103
50,0	12	1,5	755.105



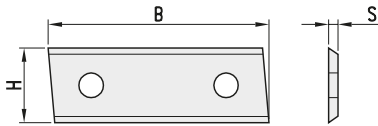

Ausführung 1 - Type 1

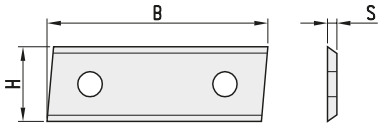

Ausführung 2 - Type 2

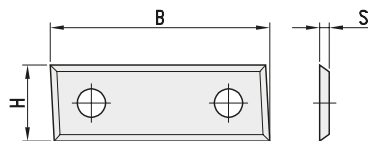

Ausführung 2 - Type 2

**Ausführung mit 2 Schneidkanten**  
*Type with 2 cutting edges*

HW

B	H	S	Art. Nr.
<b>Ausführung 1 - Type 1</b>			
20	12	1,5	757.101
30	12	1,5	757.102
50	12	1,5	757.103
<b>Ausführung 2 - Type 2</b>			
20	12	1,5	757.201
30	12	1,5	757.202
50	12	1,5	757.203

**Ausführung mit 4 Schneidkanten**  
*Type with 4 cutting edges*

HW

B	H	S	Art. Nr.
29,5	9	1,5	757.500
	12	1,5	757.150
49,5	9	1,5	757.501
	12	1,5	757.151

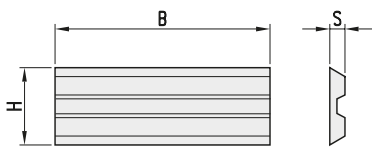

Ausführung 1 - Type 1

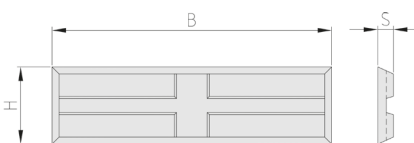

Ausführung 2 - Type 2

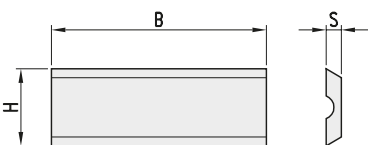

Ausführung 3 - Type 3

**Ausführung 1**  
*Type 1*

HW

B	H	S	Art. Nr.
12	5,5	1,1	758.101
20	5,5	1,1	758.102
30	5,5	1,1	758.103
40	5,5	1,1	758.104
50	5,5	1,1	758.105

**Ausführung 2**  
*Type 2*

HW

B	H	S	Art. Nr.
20	4,1	1,1	758.411
20	5,5	1,1	758.511
25	5,5	1,1	758.512
30	5,5	1,1	758.503
40	5,5	1,1	758.504
50	5,5	1,1	758.505

**Ausführung 3**  
*Type 3*

HW

B	H	S	Art. Nr.
12	5,5	1,1	758.301
20	5,5	1,1	758.302
30	5,5	1,1	758.303
40	5,5	1,1	758.304
50	5,5	1,1	758.305

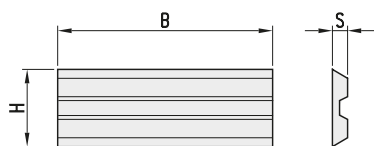
**Ausführung mit 2 Schneidkanten**  
*Type with 2 cutting edges*
**HW**

B	H	S	Maschine	Art. Nr.
56,0	5,5	1,1	Adler	<b>759.101</b>
60,0	5,5	1,1		<b>759.102</b>
71,0	5,5	1,1		<b>759.103</b>
75,5	5,5	1,1	AEG TH75	<b>759.104</b>
			Bosch 0590,P400, 1590, 1591	
			Festo REP 75	
			Haffner FH 222	
			Holz-Her 2223, 2286, 2320	
			Kress Jet Star 6701, EH 6702	
			Mafell HU 75	
			Metabo 6375	
			Scheer MH 80, MH 75/3	
			Skill 98 H	
75,7	5,5	1,1	B & Decker DN 750, BD 750	<b>759.105</b>
			SR 600K	
78,0	5,5	1,1	Virutex (E) HTH75A	<b>759.110</b>
80,5	5,9	1,2	Elu MFF80, MFF 40	<b>759.106</b>
			ADE 80	
82,0	5,5	1,1	AEG EH 82, EH 82S, EH 822	<b>759.107</b>
			EH700, EH450	
			Fein HS 2151	
			Haffner FH 224	
			Hitachi F20, F20A, P20 SA, P 10V	
			F20 20A, FU 20 SA	
			Mafell EHU 82, MHU 82, MHU 82D	
			Makita 1100,1125B, 1900B, 1923B	
			1923 H, 1001, 1901, 1923 HO	
			Metabo Gustav, 4382, HO 0882	
			Bosch GHO40, PHO 150, 100, 200, 300	
82,7	5,5	1,1	B & Decker DN 710, Dn 172, DN 730	<b>759.109</b>
			P71-02, PL 806	

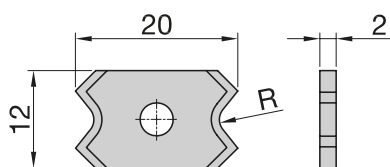

**Radius-Kantenmesser, Ausführung mit 2 Schneidkanten**  
*Radius-knife, type for scraper with 2 cutting edges*
**HW**

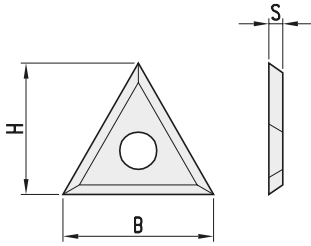
B	H	S	Art. Nr.
12	20	2	<b>798.101</b>
	20	2	<b>798.102</b>
	20	3	<b>798.103</b>
	20	4	<b>798.104</b>
	20	5	<b>798.105</b>

**760****HW Dreiecks Wendemesser**  
*TC Triangle reversible knives***PG**  
**02****Ausführung mit 3 Schneidkanten**  
*Type with 3 cutting edges***HW**

B	H	S	R	Art. Nr.
22	19	2		<b>760.101</b>
	19	2	1	RH <b>760.201</b>
	19	2	1	LH <b>760.202</b>

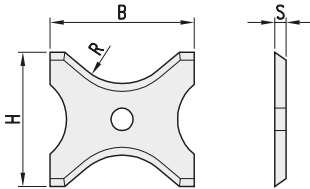
- ▲ Dreieckswendemesser mit gerundeten Kanten (R=1) für Innenkontur
- ▲ *Triangle Knives with rounded edges for inner contour*

**761****HW Radius Wendemesser**  
*TC Radius reversible knives***PG**  
**02****Ausführung mit 2 Schneidkanten**  
*Type with 2 cutting edges***HW**

B	H	S	R	Art. Nr.
13	16	2	2	<b>761.101</b>
	16	2	3	<b>761.102</b>
	16	2	4	<b>761.103</b>
20	21	2	5	<b>761.104</b>
	21	2	6	<b>761.105</b>
	21	2	7	<b>761.106</b>
	21	2	8	<b>761.107</b>
26	24	2	9	<b>761.108</b>
	24	2	10	<b>761.109</b>
	24	2	11	<b>761.110</b>
	24	2	12	<b>761.111</b>
	24	2	13	<b>761.112</b>
30	25	2	14	<b>761.113</b>
	25	2	15	<b>761.114</b>
	25	2	16	<b>761.115</b>

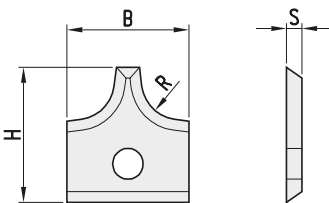
**765****HW Radius Wendemesser**  
*TC Radius reversible knives***PG**  
**02****Ausführung mit 2 Schneidkanten**  
*Type with 2 cutting edges***HW**

B	H	S	R	Art. Nr.
16	17,5	2	2	<b>765.101</b>
	17,5	2	3	<b>765.102</b>
	17,5	2	4	<b>765.103</b>
	17,5	2	5	<b>765.104</b>
	17,5	2	6	<b>765.105</b>

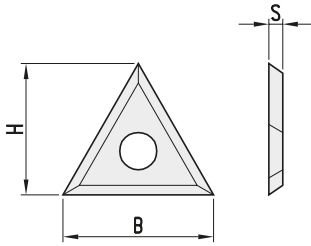
**766****HW Räumler - Wendemesser**  
TC Groovers - Reversible knives**PG  
02****Ausführung mit 4 Schneidkanten**  
Type with 4 cutting edges**HW**

B	H	S	Art. Nr.
18	18	1,95	<b>766.101</b>
	18	2,45	<b>766.102</b>
	18	2,95	<b>766.103</b>

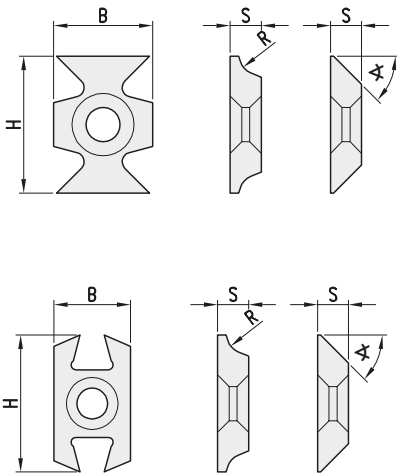
**780****HW Kantenmesser**  
TC Bevelling and rounding blades**PG  
02****Ausführung mit 2 Schneidkanten**  
Type with 2 cutting edges**MEC****HW**

B	H	S	R $\alpha$	Art. Nr.
16	22	5	45°	<b>780.103</b>
	22	5	R1,5	<b>780.205</b>
	22	5	R2	<b>780.207</b>
	22	5	R2,5	<b>780.208</b>
	22	5	R3	<b>780.206</b>
	22	5	4	<b>780.209</b>
	22	5	5	<b>780.210</b>

**Ausführung mit 2 Schneidkanten**  
Type with 2 cutting edges**MAN****HW**

B	H	S	R $\alpha$	Art. Nr.
16	29	5	45°	<b>780.260</b>
	29	5	R2	<b>780.250</b>
	29	5	R3	<b>780.251</b>

01



02



03



04



05



06



07



08



09



10



11



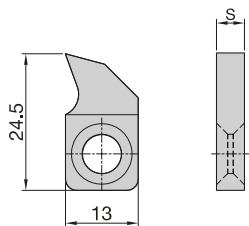

**Ausführung mit 1 Schneidkanten**  
*Type with 1 cutting edges*
**MEC****HW**

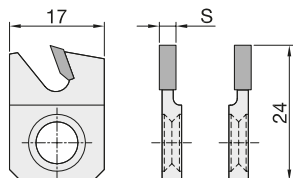
B	H	S	Art. Nr.
13	24,5	3	<b>783.100</b>
	24,5	4	<b>783.101</b>
	24,5	5	<b>783.102</b>
	24,5	6	<b>783.103</b>
	24,5	7	<b>783.104</b>

**Ausführung MAN mit 1 Schneidkante**  
*Type MAN with 1 cutting edge*
**MAN****HW**

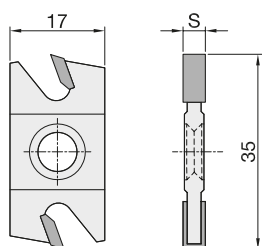
B	H	S	Art. Nr.
17	24	3	LH <b>783.125</b>
	24	3	RH <b>783.126</b>

**Ausführung mit 2 Schneidkanten**  
*Type with 2 cutting edges*
**MAN****HW**

B	H	S	Art. Nr.
17	35	4	<b>783.120</b>
	35	5	<b>783.121</b>
	35	6	<b>783.122</b>



**771**  
**773**

**HS/HW Streifenhobelmesser**  
*HS/TC Planing knives*

**PG**  
**02**

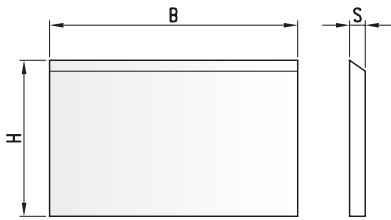

HL/HS

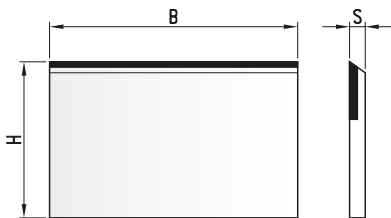

Hartmetallbestückt - Tipped knife

**Ausführung mit 1 Schneidkanten**  
*Type with 1 cutting edges*

**HS**

**HW**

B	H	S	Art. Nr.	Art. Nr.
120	25	3	771.120.25	773.120.25
130		3	771.130.25	773.130.25
150		3	771.150.25	773.150.25
180		3	771.180.25	773.180.25
200		3	771.200.25	773.200.25
250		3	771.250.25	773.250.25
260		3	771.260.25	773.260.25
310		3	771.310.25	773.310.25
350		3	771.350.25	773.350.25
80	30	3	771.080.30	773.080.30
100		3	771.100.30	773.100.30
120		3	771.120.30	773.120.30
130		3	771.130.30	773.130.30
150		3	771.150.30	773.150.30
170		3	771.170.30	773.170.30
180		3	771.180.30	773.180.30
200		3	771.200.30	773.200.30
220		3	771.220.30	773.220.30
230		3	771.230.30	773.230.30
240		3	771.240.30	773.240.30
250		3	771.250.30	773.250.30
260		3	771.260.30	773.260.30
300		3	771.300.30	773.300.30
350		3	771.350.30	773.350.30
400		3	771.400.30	773.400.30
410		3	771.410.30	773.410.30
450		3	771.450.30	773.450.30
500		3	771.500.30	773.500.30
510		3	771.510.30	773.510.30
530		3	771.530.30	773.530.30
600		3	771.600.30	773.600.30
610		3	771.610.30	773.610.30
630		3	771.630.30	773.630.30
640		3	771.640.30	773.640.30
350	35	3	771.350.35	773.350.35
400		3	771.400.35	773.400.35
410		3	771.410.35	773.410.35
450		3	771.450.35	773.450.35
500		3	771.500.35	773.500.35
510		3	771.510.35	773.510.35
530		3	771.530.35	773.530.35
600		3	771.600.35	773.600.35
610		3	771.610.35	773.610.35
630		3	771.630.35	773.630.35

- Weitere Längen auf Anfrage
- *Different lengths upon request*

**Für Elektrohobelmaschinen**  
*For portable planers*

**HS**

**HW**

B	H	S	Art. Nr.	Art. Nr.
78	25	3,2 Virutex	771.078.25	773.078.25
82	29	3,0 Makita	771.082.29	773.082.29



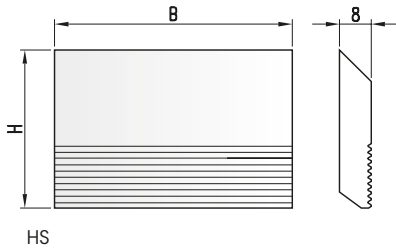

HS

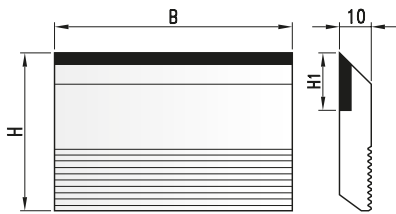

Hartmetallbestückt - Tipped knife

**Mit 1 Schneidkante**  
*With 1 cutting edge*

**HW**

**HS**

B	H	H1	T	Art. Nr. HW	Art. Nr. HS
<b>4mm-Blanketts</b>					
40	30		4		774.040.30
60					774.060.30
80					774.080.30
100					774.100.30
180					774.180.30
240					774.240.30
650					774.650.30
40	35		4		774.040.35
60					774.060.35
80					774.080.35
100					774.100.35
180					774.180.35
240					774.240.35
650					774.650.35
<b>5mm-Blanketts</b>					
40	27	14	5	787.040.27	774.040.27
60				787.060.27	774.060.27
80				787.080.27	774.080.27
100				787.100.27	774.100.27
180				787.180.27	774.180.27
240				787.240.27	774.240.27
650				787.650.27	774.650.27
40	38	15	5	787.040.38	774.040.38
60				787.060.38	774.060.38
80				787.080.38	774.080.38
100				787.100.38	774.100.38
180				787.180.38	774.180.38
240				787.240.38	774.240.38
650				787.650.38	774.650.38
40	45	17	5	787.040.45	774.040.45
60				787.060.45	774.060.45
80				787.080.45	774.080.45
100				787.100.45	774.100.45
180				787.180.45	774.180.45
240				787.240.45	774.240.45
650				787.650.45	774.650.45
40	50		5		774.040.05
60					774.060.05
80					774.080.05
100					774.100.05
180					774.180.05
240					774.240.05
650					774.650.05

**787**  
**774**

**HW/HS Hobelmesser Blanketts - Rückenverzahnt**  
*TC/HS Corrugated back knives*

**PG**  
**02**

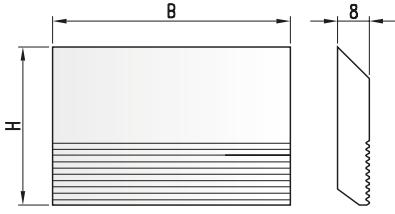

HS

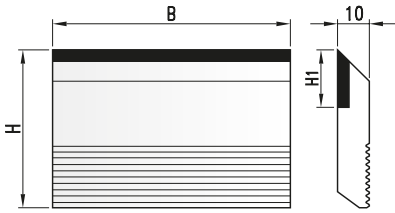

Hartmetallbestückt - Tipped knife

**Mit 1 Schneidkante**  
*With 1 cutting edge*

**HW**

**HS**

B	H	T	Art. Nr. HS
<b>6mm-Blanketts</b>			
40	40	6	<b>774.040.40</b>
60			<b>774.060.40</b>
80			<b>774.080.40</b>
100			<b>774.100.40</b>
180			<b>774.180.40</b>
240			<b>774.240.40</b>
650			<b>774.650.40</b>
40	50	6	<b>774.040.51</b>
60			<b>774.060.51</b>
80			<b>774.080.51</b>
100			<b>774.100.51</b>
180			<b>774.180.51</b>
240			<b>774.240.51</b>
650			<b>774.650.51</b>
40	60	6	<b>774.040.06</b>
60			<b>774.060.06</b>
80			<b>774.080.06</b>
100			<b>774.100.06</b>
180			<b>774.180.06</b>
240			<b>774.240.06</b>
650			<b>774.650.06</b>
40	70	6	<b>774.040.07</b>
60			<b>774.060.07</b>
80			<b>774.080.07</b>
100			<b>774.100.07</b>
180			<b>774.180.07</b>
240			<b>774.240.07</b>
650			<b>774.640.07</b>

- Weitere Längen auf Anfrage
- *Different lengths upon request*



**787**  
**774**

**HW/HS Hobelmesser Blanketts - Rückenverzahnt**  
*TC/HS Corrugated back knives*

**PG**  
**02**

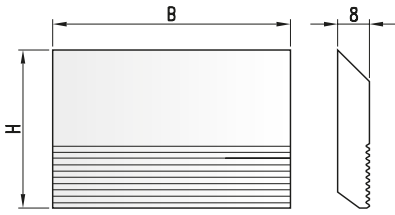

HS

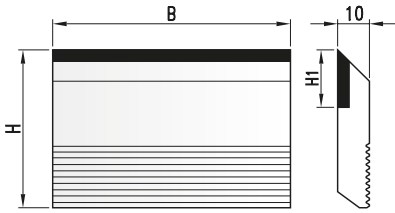

Hartmetallbestückt - Tipped knife

**Mit 1 Schneidkante**  
*With 1 cutting edge*

**HW**

**HS**

B	H	H1	T	Art. Nr. HW	Art. Nr. HS
<b>8mm-Blanketts</b>					
40	50	15	8	<b>787.040.50</b>	<b>774.040.50</b>
60				<b>787.060.50</b>	<b>774.060.50</b>
80				<b>787.080.50</b>	<b>774.080.50</b>
100				<b>787.100.50</b>	<b>774.100.50</b>
130				<b>787.130.50</b>	<b>774.130.50</b>
150				<b>787.150.50</b>	<b>774.150.50</b>
180				<b>787.180.50</b>	<b>774.180.50</b>
230				<b>787.230.50</b>	<b>774.230.50</b>
635				<b>787.645.50</b>	<b>774.635.50</b>
650					<b>774.650.50</b>
40	60	20	8	<b>787.040.60</b>	<b>774.040.60</b>
60				<b>787.060.60</b>	<b>774.060.60</b>
80				<b>787.080.60</b>	<b>774.080.60</b>
100				<b>787.100.60</b>	<b>774.100.60</b>
130				<b>787.130.60</b>	<b>774.130.60</b>
150				<b>787.150.60</b>	<b>774.150.60</b>
180				<b>787.180.60</b>	<b>774.180.60</b>
230				<b>787.230.60</b>	<b>774.230.60</b>
635				<b>787.635.60</b>	<b>774.635.60</b>
650					<b>774.650.60</b>
40	70	25	8	<b>787.040.70</b>	<b>774.040.70</b>
60				<b>787.060.70</b>	<b>774.060.70</b>
80				<b>787.080.70</b>	<b>774.080.70</b>
100				<b>787.100.70</b>	<b>774.100.70</b>
130				<b>787.130.70</b>	<b>774.130.70</b>
150				<b>787.150.70</b>	<b>774.150.70</b>
180				<b>787.180.70</b>	<b>774.180.70</b>
230				<b>787.230.70</b>	<b>774.230.70</b>
635				<b>787.635.70</b>	<b>774.635.70</b>
650					<b>774.650.70</b>

- Weitere Längen auf Anfrage
- *Different lengths upon request*

792

## HW Hobelmesser mit Mikroverzahnung - Massiv

TC Micro corrugated planerknife - Solid

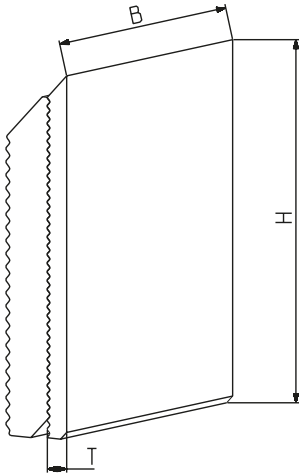
PG  
02

Mit 1 Schneidkante  
With 1 cutting edge

HW

B	H	T	Art. Nr.
40	38	3,2	792.040.038
60	38	3,2	792.060.038
80	38	3,2	792.080.038
100	38	3,2	792.100.038
150	38	3,2	792.150.038
170	38	3,2	792.170.038
40	50	3,2	792.040.050
50	50	3,2	792.050.050
60	50	3,2	792.060.050
80	50	3,2	792.080.050
100	50	3,2	792.100.050
120	50	3,2	792.120.050
40	60	3,2	792.040.060
50	60	3,2	792.050.060
60	60	3,2	792.060.060
80	60	3,2	792.080.060
100	60	3,2	792.100.060
120	60	3,2	792.120.060
130	60	3,2	792.130.060
150	60	3,2	792.150.060

793

## WS Stützplatte mit Mikroverzahnung und Rückenverzahnung

WS Micro corrugated and backserrated support

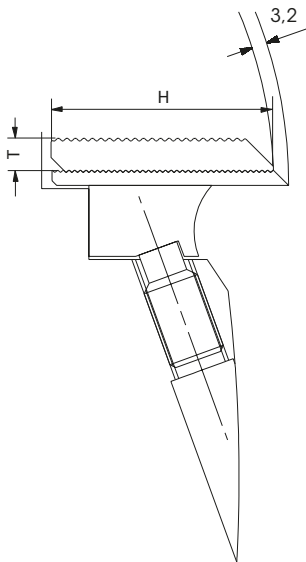
PG  
02

Beidseitig verzahnte Stützplatte  
Backing plate corrugated on both sides

HW

B	H	T	Art. Nr.
40	35	7,1	793.040.035
50	35	7,1	793.050.035
60	35	7,1	793.060.035
100	35	7,1	793.100.035
40	47	7,1	793.040.047
50	47	7,1	793.050.047
60	47	7,1	793.060.047
80	47	7,1	793.080.047
100	47	7,1	793.100.047
130	47	7,1	793.130.047
150	47	7,1	793.150.047
170	47	7,1	793.170.047
40	57	7,1	793.040.057
50	57	7,1	793.050.057
60	57	7,1	793.060.057
70	57	7,1	793.070.057
80	57	7,1	793.080.057
90	57	7,1	793.090.057
100	57	7,1	793.100.057
110	57	7,1	793.110.057
120	57	7,1	793.120.057
130	57	7,1	793.130.057

01



02



03



04



05



06



07



08



09



10



11

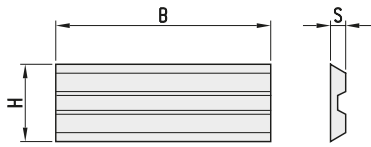

**776**  
**796****HS/HW „CentroLock“ Hobelmesser - Wendemesser**  
*HS/TC „CentroLock“ knives - Reversible knives***PG**  
**02****CentroLock Wendemesser**  
*CentroLock reversible knives***HW****HS**

B	H	S	Art. Nr. HS	Art. Nr. HW
20	16	3	776.020.016	796.020.016
60	16	3	776.060.016	796.060.016
70	16	3	776.070.016	796.070.016
80	16	3	776.080.016	796.080.016
85	16	3	776.085.016	796.085.016
100	16	3	776.100.016	796.100.016
110	16	3	776.110.016	796.110.016
130	16	3	776.130.016	796.130.016
150	16	3	776.150.016	796.150.016
160	16	3	776.160.016	796.160.016
170	16	3	776.170.016	796.170.016
180	16	3	776.180.016	796.180.016
190	16	3	776.190.016	796.190.016
200	16	3	776.200.016	796.200.016
210	16	3	776.210.016	796.210.016
220	16	3	776.220.016	796.220.016
230	16	3	776.230.016	796.230.016
240	16	3	776.240.016	796.240.016
250	16	3	776.250.016	796.250.016
260	16	3	776.260.016	796.260.016
270	16	3	776.270.016	796.270.016
275	16	3	776.275.016	796.275.016
280	16	3	776.280.016	796.280.016
290	16	3	776.290.016	796.290.016
310	16	3	776.310.016	796.310.016
350	16	3	776.350.016	796.350.016
360	16	3	776.360.016	796.360.016
450	16	3	776.450.016	796.450.016
460	16	3	776.460.016	796.460.016

- Weitere Längen auf Anfrage
- *Different lengths upon request*

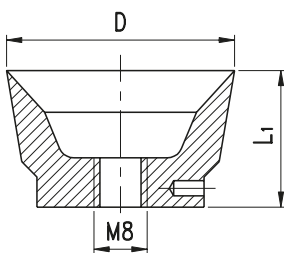
**3458****HS Messer für Kopiereinheit**  
*HS Tool for copying lathe***PG**  
**02****Rundmesser**  
*Round type***HS**

D	L1	Art. Nr.
22	15	3458.022.015
30	19	3458.030.019
35	20	3458.035.020
45	26	3458.045.026
50	26	3458.050.026

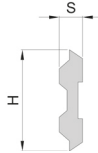
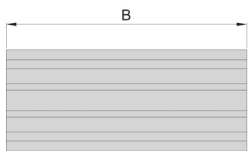
**759**  
**859****HS/HW „Tersa“ Hobelmesser - Wendemesser**  
**HS/TC „Tersa“ knives - Reversible knives****PG**  
**02****Ausführung mit 2 Schneidkanten**  
*Type with 2 cutting edges***HS****HW**

<b>B</b>	<b>H</b>	<b>S</b>	<b>Art. Nr. HS</b>	<b>Art. Nr. HW</b>
60	10	2,3	<b>759.060.010</b>	<b>859.060.010</b>
80	10	2,3	<b>759.080.010</b>	<b>859.080.010</b>
100	10	2,3	<b>759.100.010</b>	<b>859.100.010</b>
110	10	2,3	<b>759.110.010</b>	<b>859.110.010</b>
130	10	2,3	<b>759.130.010</b>	<b>859.130.010</b>
150	10	2,3	<b>759.150.010</b>	<b>859.150.010</b>
170	10	2,3	<b>759.170.010</b>	<b>859.170.010</b>
210	10	2,3	<b>759.210.010</b>	<b>859.210.010</b>
230	10	2,3	<b>759.230.010</b>	<b>859.230.010</b>
260	10	2,3	<b>759.260.010</b>	<b>859.260.010</b>
280	10	2,3	<b>759.280.010</b>	<b>859.280.010</b>
310	10	2,3	<b>759.310.010</b>	<b>859.310.010</b>
330	10	2,3	<b>759.330.010</b>	<b>859.330.010</b>
360	10	2,3	<b>759.360.010</b>	<b>859.360.010</b>
410	10	2,3	<b>759.410.010</b>	<b>859.410.010</b>
450	10	2,3	<b>759.450.010</b>	<b>859.450.010</b>
510	10	2,3	<b>759.510.010</b>	<b>859.510.010</b>
610	10	2,3	<b>759.610.010</b>	<b>859.610.010</b>
640	10	2,3	<b>759.640.010</b>	<b>859.640.010</b>
710	10	2,3	<b>759.710.010</b>	
810	10	2,3	<b>759.810.010</b>	
910	10	2,3	<b>759.910.010</b>	

- Nur zur Verwendung in Tersa-Messerköpfen  
Weitere Längen auf Anfrage
- *Only for use in Tersa-cutterheads*  
*Different lengths upon request*

**01****02****03****04****05****06****07****08****09****10****11**

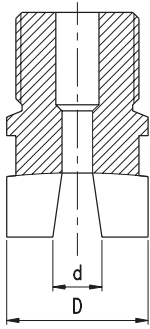
**3488****HS Stabschneider**  
*HS Cutter for wire drawing straight slats***PG  
02****Stabschneider**  
*Wire drawing straight slat cutter***HS**

D	L1	Art. Nr.
25	6,2	<b>3488.025.006</b>
	8,2	<b>3488.025.008</b>
	10,2	<b>3488.025.010</b>
	12,2	<b>3488.025.012</b>

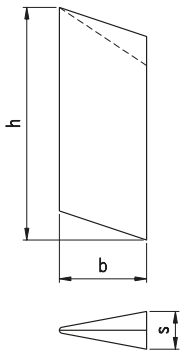
**3910****HW/HS/ST Abstechstahl**  
*TC/HS/ST Tool for copying lathe***PG  
02****Abstechstahl**  
*Copying lathe tool***HS**

b	s	h	Schneidstoff/material	Art. Nr.
25	9,5	100	HS/HS	<b>3910.025.010</b>
	9,5	100	ST/Stellite	<b>3910.025.110</b>
	9,5	100	HW/TC	<b>3910.025.210</b>
40	15,0	110	HS/HS	<b>3910.040.015</b>
	15,0	110	ST/Stellite	<b>3910.040.115</b>
	15,0	110	HW/TC	<b>3910.040.215</b>

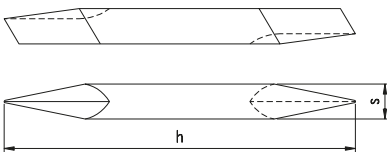
**3910****HS Abstechstahl**  
*HS Tool for copying lathe***PG  
02****Abstechstahl**  
*Copying lathe tool***HS**

D	L1	Art. Nr.
16	150	<b>3910.016.150</b>
20	200	<b>3910.020.200</b>

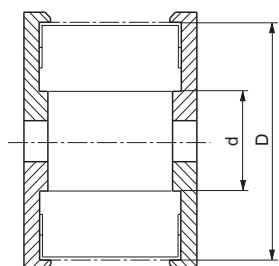

**Einstell-Lehre**  
*Adjustment gauge*
**HS**Einstell-Lehre - *Adjustment gauge***Art. Nr.**  
**717.600**
**Messer - Einstell-Lehre**  
*Knife - Adjustment gauge*

D	d	Art. Nr.
125	30	717.201
140		717.202
150		717.203
125	40	717.204
140		717.205
150		717.206
125	50	717.207
140		717.208
150		717.209
163	50	717.210

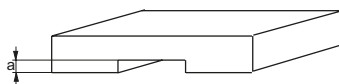
**Messer - Einstell-Lehre**  
*Knife - Adjustment gauge*

a	Art. Nr.
1	717.302
0,3/0,8	717.309
0,3/1,3	717.310



**Gewindestifte und Schrauben**  
*Set-screws and screws*

DIN 915



DIN 916

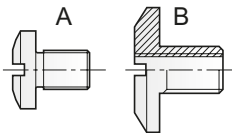
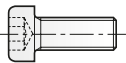
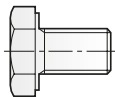
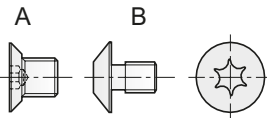
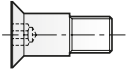

D	Art. Nr.	
<b>Gewindestift mit Innensechskant und Zapfen - DIN 915 Hex socket setscrew</b>		
M5 x 12	705.523	
M5 x 16	705.582	
M6 x 10	705.532	
M6 x 12	705.533	
M6 x 16	705.535	
M8 x 12	705.541	
M8 x 16	705.542	
M8 x 20	705.544	
M8 x 25	705.543	
M10 x 16	705.551	
M10 x 20	705.552	
M10 x 25	705.553	
M12 x 20	705.556	
<b>Gewindestift mit Innensechskant und Kegelschuppe - DIN 916 Slotted countersink screw</b>		
M2,5 x 2,5	705.100	
M4 x 4	705.101	
M5 x 5	705.102	
M5 x 8	705.511	
M5 x 10	705.103	
M6 x 6	705.583	
<b>Zylinderschraube-Senkopf mit Innensechskant - Countersink with collar</b>		
M5 x 13,5	705.318	
<b>TORX-Schrauben - Screw TORX</b>		
M4 x 3,2	Ausführung /Type A	705.313
M4 x 4,2		705.314
M5 x 7		705.425
M3,5 x 7,5	Ausführung /Type B	705.350
M3,5 x 4		705.352
M4 x 4		705.353
M4 x 6		705.351
M4 x 9		705.354
<b>Torxmuttern für Wendeschneidmesser - Special nut for groover</b>		
M4 x 1,6 (Ø9,9)		709.128
M4 x 1,7 (Ø11,9)		709.129
M4 x 2,3 (Ø11,9)		709.127
<b>Sechskantschrauben mit Gewinde bis zum Kopf - Hex head screw</b>		
M10 x 12		705.432
M10 x 17		705.433
<b>Zylinderschraube mit Innensechskant - Hex socket cap screw</b>		
1/8"		705.501
3/32"		705.502
<b>Spezial-Rundkopfschraube - Special round head screw</b>		
M5 x 7/Ø10	Ausführung /Type A	705.217
M5 x 7/Ø16		705.214
M6 x 6/Ø16	Ausführung /Type B	705.218

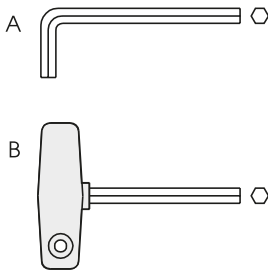
**Sechskantschlüssel**  
Hex wrench**HS**

Dim.		Art. Nr.
SW 3/32"	Ausführung/Type A	706.161
SW 5/64"		706.162
SW 1,3		706.149
SW 1,5		706.150
SW 2		706.151
SW 2,5		706.152
SW 3		706.153
SW 4		706.154
SW 5		706.155
SW 6		706.156
SW 2,5	Ausführung/Type B	706.102
SW 3		706.103
SW 4		706.104
SW 5		706.105
SW 6		706.106
SW 10		706.107

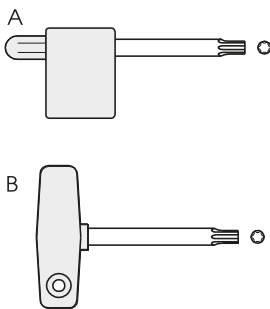
**TORX-Schlüssel**  
TORX Wrench

Dim.		Art. Nr.
TX9		706.301
TX15	Ausführung/Type A	706.302
TX9		706.303
TX15	Ausführung/Type B	706.304
TX20		706.305

**Drehmomentadapter für Bit 6kt. S=6,35mm auf Bit-Schaft 6kt. S=6,35mm zur korrekten Vorspannung von Wendeplatten mit Torx-Schrauben**

*Torque adapter for bit hex. S=6.35mm to bit shank hex. S=6.35mm for correct pretensioning of inserts with Torx screws*

**Einzelner Drehmomentadapter in Ausführung auch zum Betrieb in Handbohrmaschinen geeignet**  
*Single torque adapter in version also suitable for operation in hand drills*

M[Nm]	TX	Art. Nr.
Voreingestelltes Drehmoment Set inkl. div. Torx Bits, T-Griff und Drehmomentadapter <i>Pre-set torque set incl. various Torx bits, T-handle and torque adapter</i>		
2,0 Nm	TX09	923.009.20
3,0 Nm	TX15	923.015.30
5,5 Nm	TX20	923.025.50

**Set für eine Torx-Größe inkl. T-Griff Schlüssel und Torx-Bits mit unterschiedlicher Länge**  
*Set for one Torx size incl. T-handle spanner and Torx bits with different lengths*

M[Nm]	TX	Art. Nr.
Drehmomentadapter Sets - Voreingestelltes Drehmoment - <i>Torque adapter sets - Pre-set torque</i>		
2,0 Nm	TX09	922.009.20
3,0 Nm	TX15	922.015.30
5,5 Nm	TX20	922.020.55

**Set für unterschiedliche Torx-Größen inkl. T-Griff Schlüssel und div. Torx-Bits für gelistete Torx-Größen**  
*Set for different Torx sizes incl. T-handle spanner and various Torx bits for listed Torx sizes*

M[Nm]	TX	Art. Nr.
Set inkl. div. Torx Bits TX6-TX20 und T-Griff mit div. Drehmomenten <i>Set incl. various Torx bits TX6-TX20 and T-handle with various torques</i>		
0,6 Nm	TX6	
0,9 Nm	TX7	
1,2 Nm	TX8	
2,0 Nm	TX9	
3,0 Nm	TX15	
5,5 Nm	TX20	

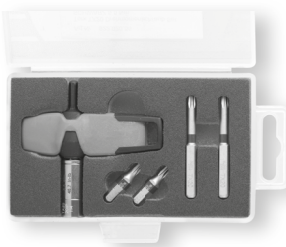

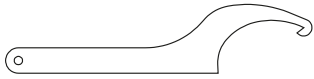

**Hakenschlüssel**  
Hook Wrench

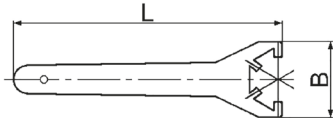
D min. - D max.	L	Für Spannmuttern	Art. Nr.
30/32	136	426E/ER16	<b>706.505</b>
34/36	170	428E/ER20	<b>706.507</b>
40/42	170	430E/ER25	<b>706.500</b>
45/50	206	470E/ER32	<b>706.504</b>
58/62	240	462E/OZ25	<b>706.503</b>
68/75	240	472E/ER40	<b>706.501</b>
80/90	280	477E/ER50 468E/OZ40	<b>706.502</b>

**Schlüssel für Muttern mit 6 Nuten**  
Spanner for nuts with 6 grooves

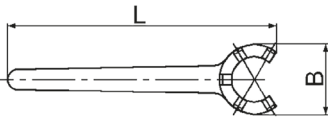
L	B	Für Spannmuttern	Art. Nr.
163	50	ER16	<b>706.016</b>
180	60	ER20	<b>706.701</b>
210	65	ER25	<b>706.711</b>
253	75	ER32	<b>706.709</b>
290	88	ER40	<b>706.715</b>
350	110	ER50	<b>706.71</b>



**Schlüssel für Minimuttern**  
Spanner for mini nuts

L	B	Für Spannmuttern	Art. Nr.
117	22,5	ER16	<b>706.716</b>
128	28	ER20	<b>706.714</b>
145	36	ER25	<b>706.712</b>

**HSK85WS Montagestand**  
HSK85WS assemblystand

HS

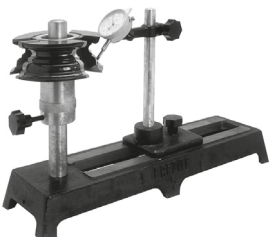
Bezeichnung	Art. Nr.
HSK85WS-Messspindel	<b>835.250.015</b>

**Messtisch mit Messuhr**  
Table of geometric control

HS

Art. Nr.
<b>719.101</b>

723

## Hobelmesser-Schneidenflugkreis-Prüf- und Einstellhilfe

Control device for planing knives

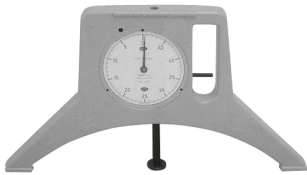
PG  
02

**Messer Prüf- und Einstellhilfe**  
Control device for knives

HS

Art. Nr.  
835.250.015

4000  
4400

## Entharzer - Sprühflasche

Cleaning liquid-aerosol can

PG  
02

**Cleaner Universal Reinigungsmittel**  
Cleaning liquid

Bezeichnung	Verpackungseinheit	Art. Nr.
1 Liter Sprühflasche Entharzer für Alu-Werkzeuge	6	4400.0100
1 Liter Entharzer für Stahl-Werkzeuge	1	4000.0100

Schnellentharzer für universelle Verwendung. Beseitigt normale und schwierige, organische und anorganische Verschmutzungen auf sämtlichen Werkzeugen.

- Keine gesundheitsschädlichen Inhaltsstoffe.
- Biologisch abbaubar.
- Reinigt schnell und rückstandsfrei

*Resin cleaning agent for removal of resin and cleaning of tools.*

- No noxious ingredients
- biodegradable
- Cleans quick and residue-free

**Achtung:** Es lohnt sich Werkzeuge öfters zu entharnen. Verharzte Werkzeuge verringern erheblich die Standwege, verschlechtern die Schnittgüte und erhöhen die Stromkosten.

**Attention:** It's worth to clean tool frequently. Resined tools shorten tool life, worsen quality of cut and heighten electricity costs.

4000  
4400

## Entharzer für Werkzeuge aus Stahl und Aluminium

Cleaner for steel- and aluminium-tools

PG  
02

**AX-Entharzer für Aluminium-Werkzeuge**  
AX-Cleaner for Alu-tools

Bezeichnung	Verpackungseinheit	Art. Nr.
5 Liter Kanister Konzentrat	5l	4400.0500
Verdünnen 1:10 mit Wasser		

*5 liter canister master batch, to dilute with 50 liter of water*

Anwendung: Schnellentharzer für Werkzeug aus Aluminium

**SX-Cleaner für Stahl**  
SX-Cleaning liquid for steel-tools

Bezeichnung	Verpackungseinheit	Art. Nr.
5 Liter Kanister Konzentrat	5l	4000.0500
Verdünnen 1:5 mit Wasser		

*5 liter canister master batch, to dilute with 25 liter of water*

Anwendung: Schnellentharzer für Werkzeug aus Stahl  
Werkzeuge aus Aluminium dürfen mit dem Cleaner nicht in Berührung kommen.

**Attention:** Only for steel tools. Do not use for aluminium-tools.

01



02



03



04



05



06



07



08



09



10



11



